



## Evolution3™ range

### Making accurate cutting easier than ever before

The ultimate tool for a busy production environment

- Quick and easy to use - saves time and money
- Reliable and built to last with a 5-year warranty
- Lift-and-Hover\* (patent pending) for fast, accurate cut alignment
- Future-proof and versatile QuikSwap tool heads
- Guaranteed ultra high precision 0.2mm accuracy
- Cuts PVC foamboard up to 13mm

#### Available Sizes:

- Available ex stock 1.6m, 2.1m, 2.6m
- Please enquire about available sizes 1.1m, 3.1m and 3.6m and custom lengths up to 5.5m

\*Available for BenchTop and SmartFold



Three models to choose from



Quick and easy to use - saves time and money



5 Year Warranty



Available in 1.1m, 1.6m, 2.1m, 2.6m, 3.1m and 3.6m cut lengths



## Quick and easy

- Raise the clamp with minimal effort
- Lift-and-Hover\* holds the cutter bar just above the media
- Anti-sag holds the cutter bar parallel to the surface of the media
- Sightline strip shows exactly where the cut will be made

## Simple to use

- Intuitive - minimal training needed
- Lift-and-Hover\* can be operated from either end
- Single person operation even with the largest sheet size

## Saves time and money

- Better alignment means fewer mistakes and less waste
- Faster working for higher productivity

## Reliable and built to last

- Designed and manufactured to Keencut's exacting standards of precision
- 5-year warranty



## Fits any suitable bench

- For the Evolution-2 bench or any appropriate existing bench

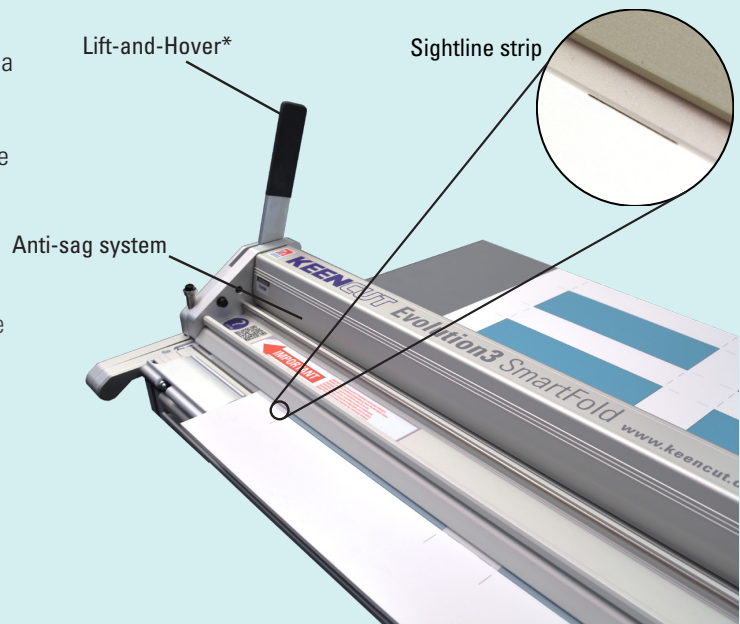
\*On the BenchTop and SmartFold



## QUIKSWAP TOOL HEADS

<b>Double Graphik tool head</b> 	<ul style="list-style-type: none"> <li>• Two-way cutting with two individual blade holders</li> <li>• Graphik blades are stronger and more stable than regular blades</li> <li>• Supplied as standard with every Evolution3</li> </ul>	Ideal for: vinyl, banner, cardboard, up to 13mm PVC foamboard, foam-centred board, corrugated plastic & paper, pop-up & roll-up materials
<b>Fabric tool head</b> 	<ul style="list-style-type: none"> <li>• Spring-loaded cutting wheel</li> <li>• Consistent pressure for reliable cutting</li> <li>• Cuts in both directions</li> </ul>	Ideal for: fabric, paper, film, vinyl, banners, delicate materials
<b>Creaser tool head</b> 	<ul style="list-style-type: none"> <li>• Creases corrugated and plain card</li> <li>• A range of creaser wheels to suit different materials</li> </ul>	Ideal for: stout paper and card, cardboard, grey board

## DIMENSIONS & TECHNICAL

FreeHand	E3FH110		E3FH160	E3FH210	E3FH260	E3FH310
Cut length	110cm (44")		160cm (64")	210cm (84")	260cm (104")	310cm (124")
Packed weight	23kg (51lbs)		29kg (64lbs)	34kg (75lbs)	40kg (89lbs)	46kg (102lbs)
Packed dimensions (LxWxH)	154x35x17cm (61x14x7")		204x35x17cm (81x14x7")	254x35x17cm (100x14x7")	304x35x17cm (120x14x7")	354x35x17cm (140x14x7")
BenchTop	E3BT110	E3BT160	E3BT210	E3BT260	E3BT310	E3BT360
Cut length	110cm (44")	160cm (64")	210cm (84")	260cm (104")	310cm (124")	360cm (142")
Packed weight	28kg (62lbs)	35kg (78lbs)	43kg (95lbs)	51kg (113lbs)	57kg (126lbs)	63kg (139lbs)
Packed dimensions (LxWxH)	160x35x17cm (63x14x7")	210x35x17cm (83x14x7")	260x35x17cm (103x14x7")	310x35x17cm (123x14x7")	360x35x17cm (142x14x7")	410x35x17cm (161x14x7")
SmartFold	E3SF110	E3SF160	E3SF210	E3SF260	E3SF310	E3SF360
Cut length	110cm (44")	160cm (64")	210cm (84")	260cm (104")	310cm (124")	360cm (142")
Packed weight	31kg (69lbs)	38kg (84lbs)	47kg (104lbs)	54kg (120lbs)	63kg (139lbs)	72kg (159lbs)
Packed dimensions (LxWxH)	160x35x17cm (63x14x7")	210x35x17cm (83x14x7")	260x35x17cm (103x14x7")	310x35x17cm (123x14x7")	360x35x17cm (142x14x7")	410x35x17cm (161x14x7")